

L246 & L846 Series Cabinet, Appliance, Door and Shower Door Pull

Finishes for Life
TANNER-FREE GUARANTEE

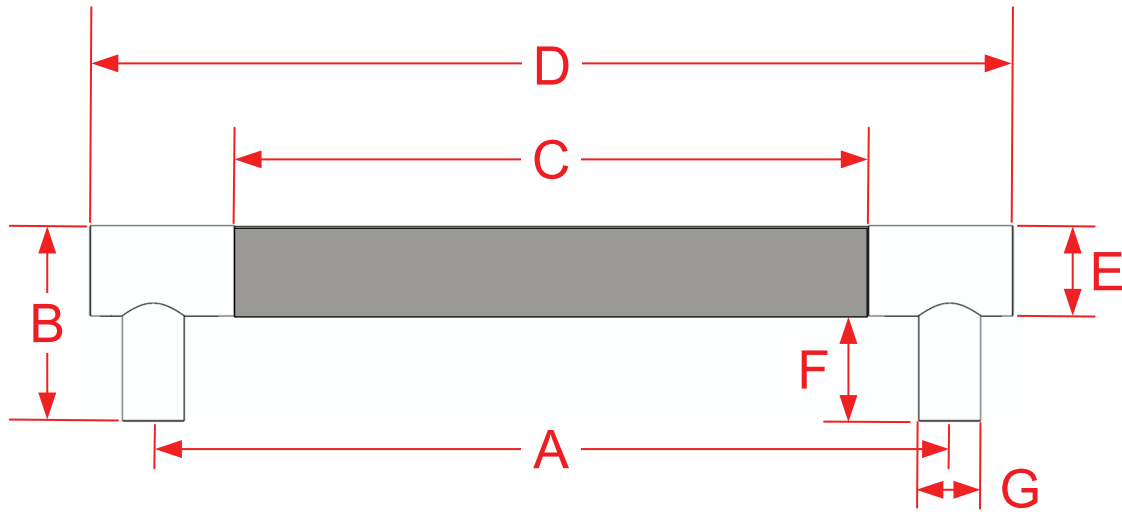
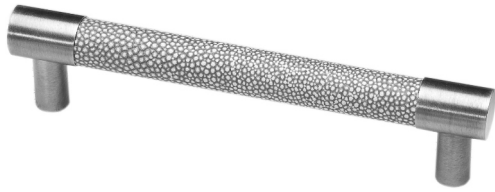

| Part # | A Center to Center | B Projection | C Leather Length | D Overall | E Diameter | F Inside Gap | G Base Diameter |
|---|-----------------------|-----------------|---------------------|--------------|---------------------------|-----------------|--------------------|
| L246-6 | 6.0000" | 1.6250" | 5.0000" | 7.0000" | 0.7500" | 0.8750" | 0.5000" |
| L246-8 | 8.0000" | 1.6250" | 7.0000" | 9.0000" | 0.7500" | 0.8750" | 0.5000" |
| L246-10 | 10.0000" | 1.6250" | 9.0000" | 11.0000" | 0.7500" | 0.8750" | 0.5000" |
| L246-12 | 12.0000" | 1.6250" | 11.0000" | 13.0000" | 0.7500" | 0.8750" | 0.5000" |
| Custom Sizing Available up to 32" Overall | | | | | Supplied with 8-32 Screws | | |
| L846-6 | 6.0000" | 1.6250" | 4.0000" | 8.0000" | 0.7500" | 0.8750" | 0.5000" |
| L846-8 | 8.0000" | 1.6250" | 6.0000" | 10.0000" | 0.7500" | 0.8750" | 0.5000" |
| L846-10 | 10.0000" | 1.6250" | 8.0000" | 12.0000" | 0.7500" | 0.8750" | 0.5000" |
| L846-12 | 12.0000" | 1.6250" | 10.0000" | 14.0000" | 0.7500" | 0.8750" | 0.5000" |
| Custom Sizing Available up to 34" Overall | | | | | Supplied with 8-32 Screws | | |

The TANNER'S CRAFT™
www.tannerscraft.com
 860.489.9233



The Tanner's Craft is a
 Division of
 Colonial Bronze
 Manufacturing Fine
 Hardware Since 1927